

## A photograph of a commercial building with a yellow and grey facade. The building features large glass windows and doors. On the left, a sign for 'my GYM' is visible above the entrance. To its right, a 'SUBWAY' sign is mounted on the wall. In the foreground, a white sign with green and yellow text reads 'SUBWAY NOW OPEN' with a yellow arrow pointing right. The building is situated on a paved street with a sidewalk in front. The sky is clear and blue.

- UNIT A2: 1,440 +/- sf Retail space
- Exterior retail sign positioning
- On-site, shared parking lot
- Zoned: B-G (Business General)
- Located on Route 62, 0.2 miles to the Middlesex Turnpike
- 0.5 miles to Route 3
- 1.1 miles to the shops at 3rd Avenue
- 1.8 miles to the Burlington Mall & Route 95/128

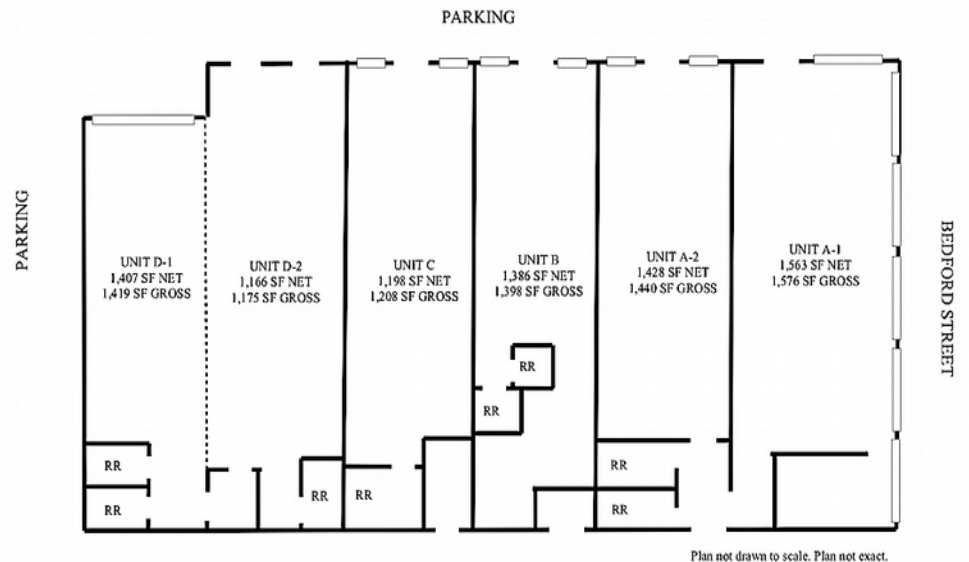

All information furnished is from sources deemed reliable, but no warranty or representation is made as to the accuracy thereof, and the same is presented subject to errors, omissions, change of price, rental or other conditions, prior sale or lease, or withdrawal without notice.  
Copyright © 2022 Carbone Commercial Real Estate, Inc., agent of the Owner/Lessor.



# 157 Bedford Street, Burlington, MA



781.935.5444 (o)  
CarboneRE.com

**CARBONE Commercial Real Estate, Inc.**