

192 New Boston Street, Woburn, MA

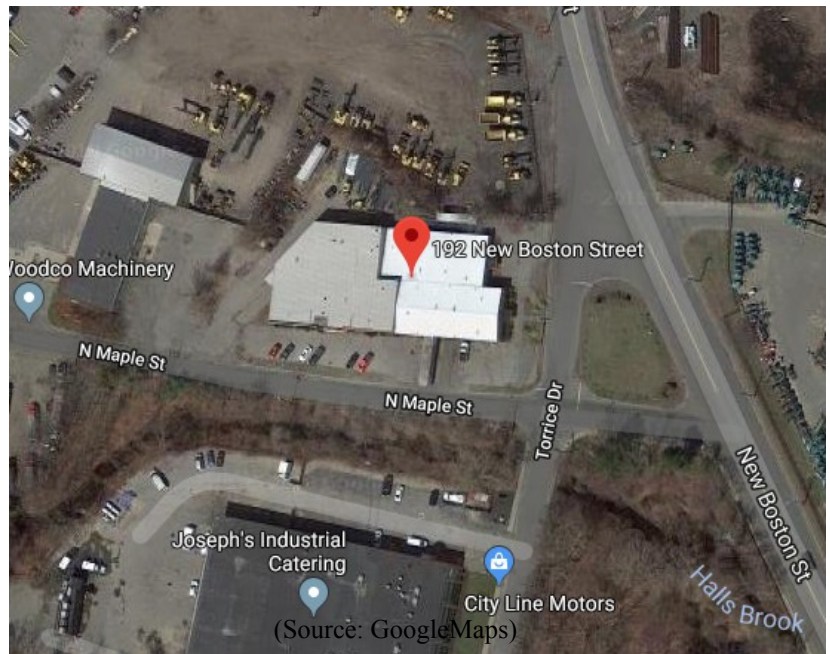

5,000 +/- SF Industrial Space For Lease

- 5,000 sf for lease
- Industrial with front office
- Ceiling is approx. 14' pitched down to 10'
- 8'x8' ground loading door
- Zoned: I-P, Industrial Park
- Heat Fuel: Natural Gas
- \$14.00 per sf



CARBONE Commercial Real Estate, Inc.

Your Professional Commercial-Investment Real Estate Source

Contact: Edward Carbone 781.935.5444 Edward@CarboneRE.com www.CarboneRE.com

All information furnished is from sources deemed reliable, but no warranty or representation is made as to the accuracy thereof, and the same is presented subject to errors, omissions, change of price, rental or other conditions, prior sale or lease, or withdrawal without notice. Copyright 2018 Carbone Commercial Real Estate, Inc., agent of the Lessor.

192 NEW BOSTON STREET, WOBURN, MA
10,000 S.F

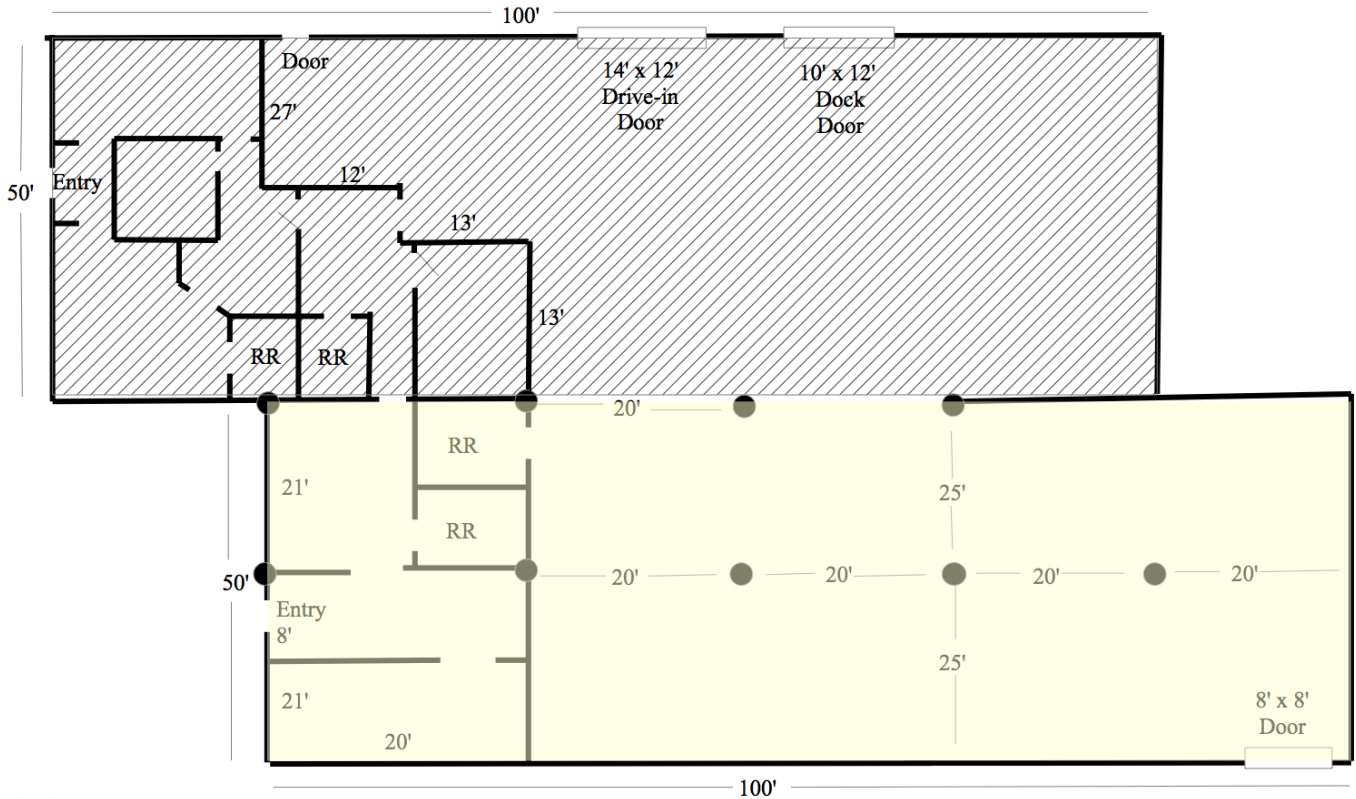

- Available 5,000 sf
- Not available

[Plan not drawn to scale. Plan not exact.]