

10 Spencer Street, Stoneham, MA



10-24 Spencer Street is a single-story, industrial office building located just outside of Stoneham Center. The building consists of 8 commercial units, front office space, and rear warehouse space with loading docks.

Warehouse with Office Space For Lease

- **UNIT 10: 5,100 +/-sf**
- Warehouse space
 - 15'H clear
 - Two tailgate level loading dock doors 12'H
 - Power: 200 amp 208v
- Office space
 - Reception + 9 offices + conference room
 - 9' Drop ceiling
 - Air conditioned
- Break room / kitchen
- 2 Private restrooms
- Gas heat
- Separate utilities: electric, gas, water
- Zoned: Business
- \$20.00 per sf plus utilities

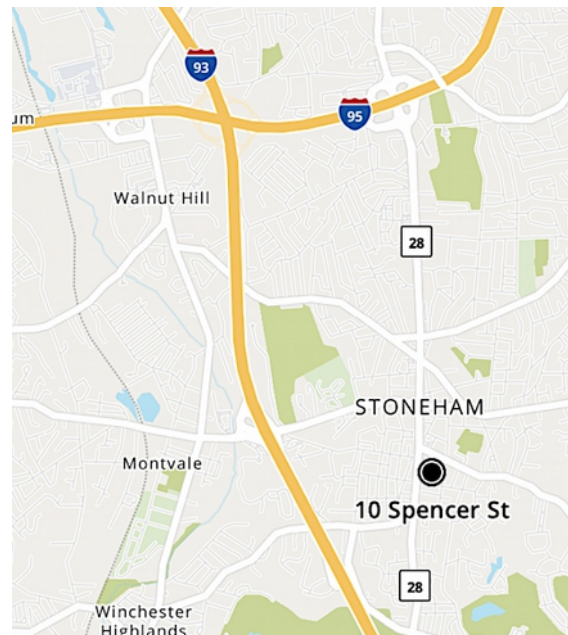

Edward Carbone, CCIM

781.935.5444 (o)

978.930.1579 (c)

Edward@CarboneRE.com

CarboneRE.com

CARBONE Commercial Real Estate, Inc.

All information furnished is from sources deemed reliable, but no warranty or representation is made as to the accuracy thereof, and the same is presented subject to errors, omissions, change of price, rental or other conditions, prior sale or lease, or withdrawal without notice. Copyright © 2024 Carbone Commercial Real Estate, Inc., agent of the Owner/Lessor.

10 SPENCER STREET, STONEHAM, MA

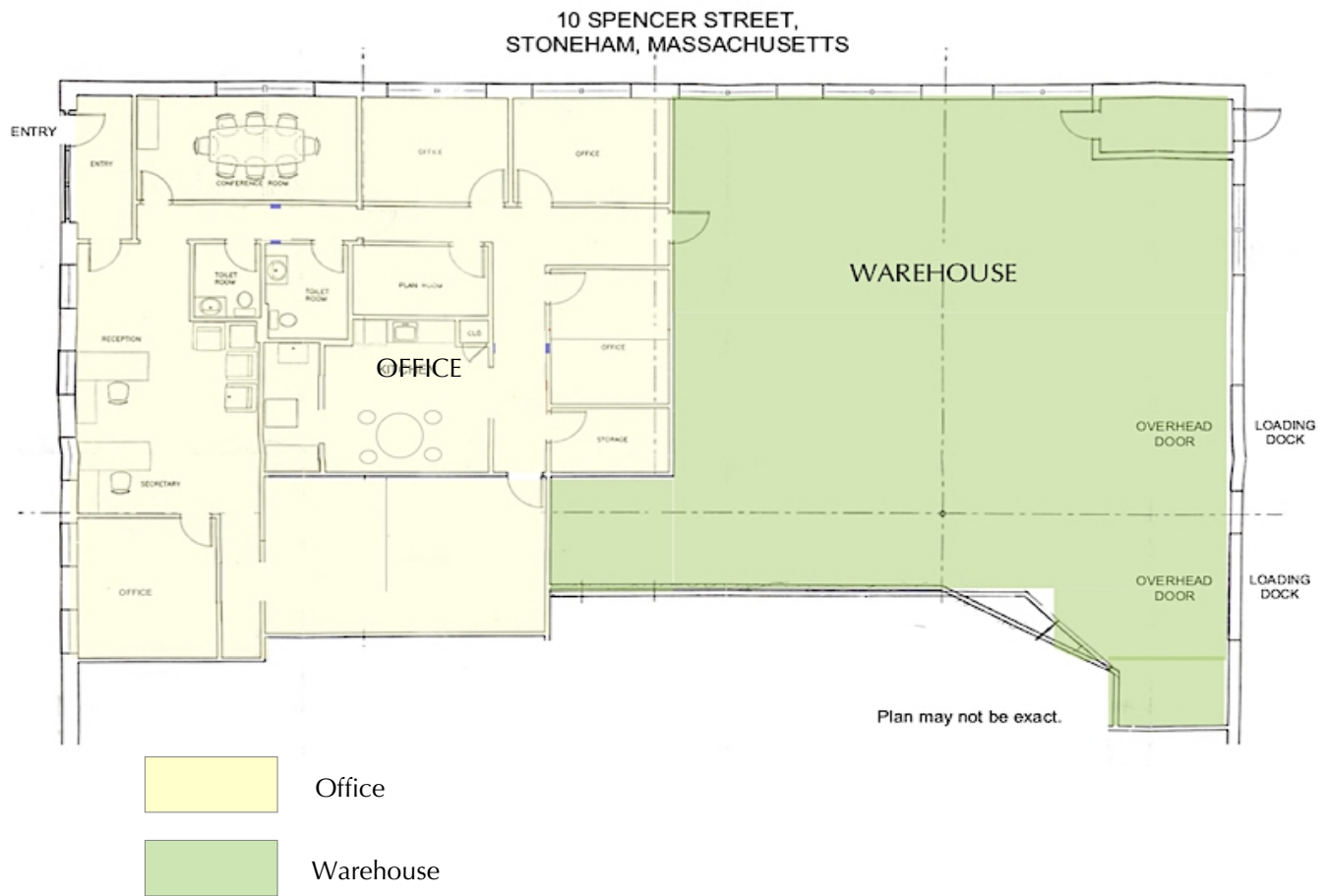

781.935.5444

CarboneRE.com

CARBONE Commercial Real Estate, Inc.

10 SPENCER STREET, STONEHAM, MA



781.935.5444
CarboneRE.com

CARBONE Commercial Real Estate, Inc.