

# 150 Sutton Street, North Andover, MA



## Two-Bay Retail Garage

- Total 1,830 +/- sf
- Two 10'H Overhead Drive-in Doors
- 12' Ceiling
- 2 Offices; 2 Restrooms
- Gas Heat
- Former JN Phillips Glass retail location
- Zoned: GB – General Business

### Potential Uses:

(per [Town of North Andover Summary of Use Regulations](#))  
auto service station\*, auto and vehicle repair  
body shop, business & other offices, car wash,  
eating & drinking establishment, medical center,  
new car sales\*, printing & production, and more.

\* see detailed District Use Regulations in Article 4.

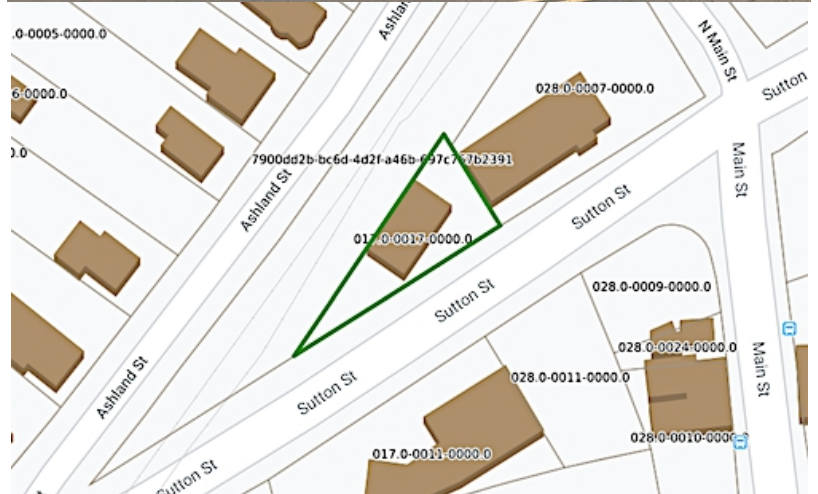

## CARBONE Commercial Real Estate, Inc.

Your Professional Commercial-Investment Real Estate Source

Contact: **Edward Carbone** 781-935-5444 [Edward@CarboneRE.com](mailto:Edward@CarboneRE.com) [www.CarboneRE.com](http://www.CarboneRE.com)

All information furnished is from sources deemed reliable, but no warranty or representation is made as to the accuracy thereof, and the same is presented subject to errors, omissions, change of price, rental or other conditions, prior sale or lease, or withdrawal without notice.  
Copyright © 2020 Carbone Commercial Real Estate, Inc., agent of the Owner/Lessor.

# 265 Ballardvale Street, Wilmington, MA

## Unofficial Property Record Card - North Andover, MA

### General Property Data

Parcel ID	017.0-0017-0000.0	Account Number	M_229976_939584
Prior Parcel ID	--	Property Location	150 SUTTON STREET
Property Owner	JNCR 150 SUTTON STREET LLC	Property Use	OTHER M/V
Mailing Address	11 WHEELING AVENUE	Most Recent Sale Date	7/2/2015
City	WOBURN	Legal Reference	14288-0090
Mailing State	MA	Grantor	FIELDKOM REALTY TRUST
Zip	01801	Sale Price	1
ParcelZoning	GB	Land Area	0.140 acres

### Current Property Assessment

Card 1 Value	Building Value	152,700	Xtra Features Value	9,800	Land Value	162,400	Total Value	324,900
--------------	----------------	---------	---------------------	-------	------------	---------	-------------	---------

### Building Description

Building Style	RETAIL	Foundation Type		Flooring Type	CONCRETE
# of Living Units	0	Frame Type	CLASS-D	Basement Floor	N/A
Year Built	1950	Roof Structure		Heating Type	WALL UNIT
Building Grade	AVERAGE+	Roof Cover	ASPHALT	Heating Fuel	N/A
Building Condition	Good	Siding	CLAPBOARD	Air Conditioning	0%
Finished Area (SF)	1830	Interior Walls	TYPICAL	# of Bsmt Garages	0
Number Rooms	0	# of Bedrooms	0	# of Full Baths	0
# of 3/4 Baths	0	# of 1/2 Baths	0	# of Other Fixtures	0

### Legal Description

### Narrative Description of Property

This property contains 0.140 acres of land mainly classified as OTHER M/V with a(n) RETAIL style building, built about 1950 , having CLAPBOARD exterior and ASPHALT roof cover, with 0 unit(s), 0 room(s), 0 bedroom(s), 0 bath(s), 0 half bath(s).

### Property Images

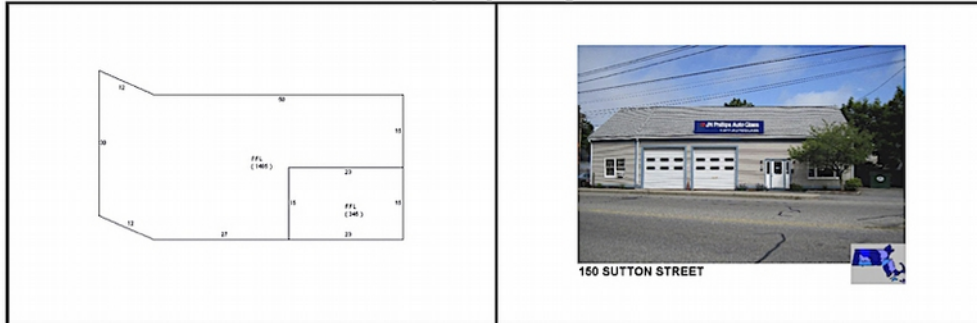

Disclaimer: This information is believed to be correct but is subject to change and is not warranted.

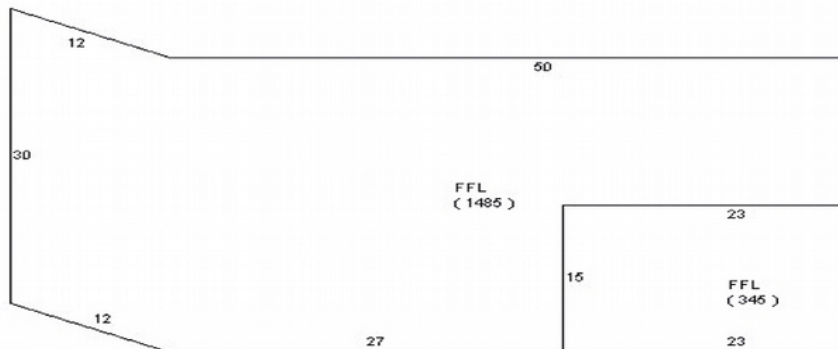

## CARBONE Commercial Real Estate, Inc.

Your Professional Commercial-Investment Real Estate Source

Contact: Edward Carbone 781-935-5444 [Edward@CarboneRE.com](mailto:Edward@CarboneRE.com) [www.CarboneRE.com](http://www.CarboneRE.com)