

323 Andover Street, Wilmington, MA



323 Andover Street is a 26,000 sf multi-tenanted industrial office building consisting of office, storage, and light manufacturing space.

Flexible options available to make this building work for your business needs. Call to discuss and arrange a tour.

13,000 +/- SF Industrial / Office Space For Lease

- 12,972 +/-sf available
- May be sub-divided
- Flexible: Open industrial, office, or a combination of both
- 3-Phase electric service
- 100% air conditioned
- 10'H Ceiling
- 5 Restrooms
- 25%+ office
- Single-story
- Loading dock
- 20 +/- parking spaces
- Common on-site daytime parking
- Zoned: General Industrial
- Located 1.1 miles to Route 93; 6.8 miles to Route 495; 7.1 miles to Route 95/128; 20 miles to Logan International Airport; and 36 miles to Manchester Regional Airport

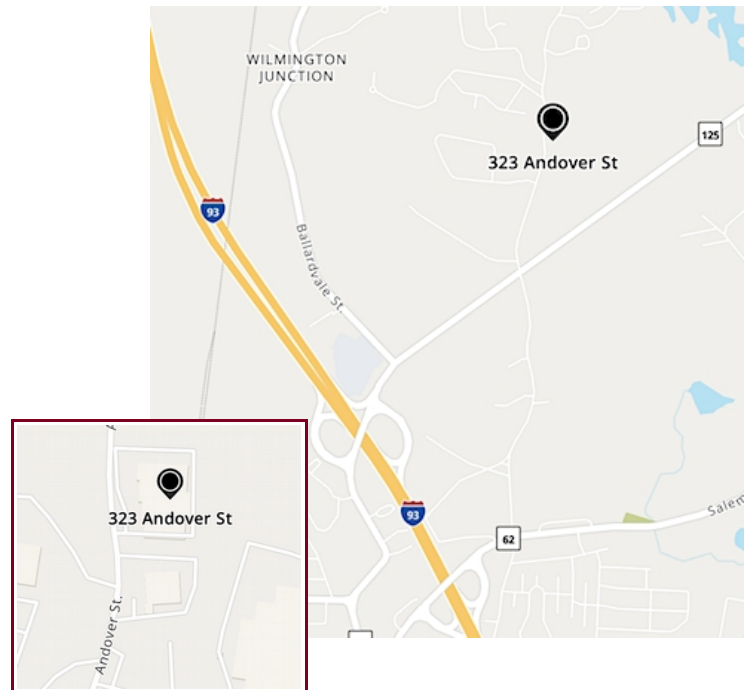

Edward Carbone, CCIM

781.935.5444 (o)

978.930.1579 (c)

Edward@CarboneRE.com

CarboneRE.com

CARBONE Commercial Real Estate, Inc.

All information furnished is from sources deemed reliable, but no warranty or representation is made as to the accuracy thereof, and the same is presented subject to errors, omissions, change of price, rental or other conditions, prior sale or lease, or withdrawal without notice. Copyright © 2025 Carbone Commercial Real Estate, Inc., agent of the Owner/Lessor.



Plans not drawn to scale. Plans not exact.

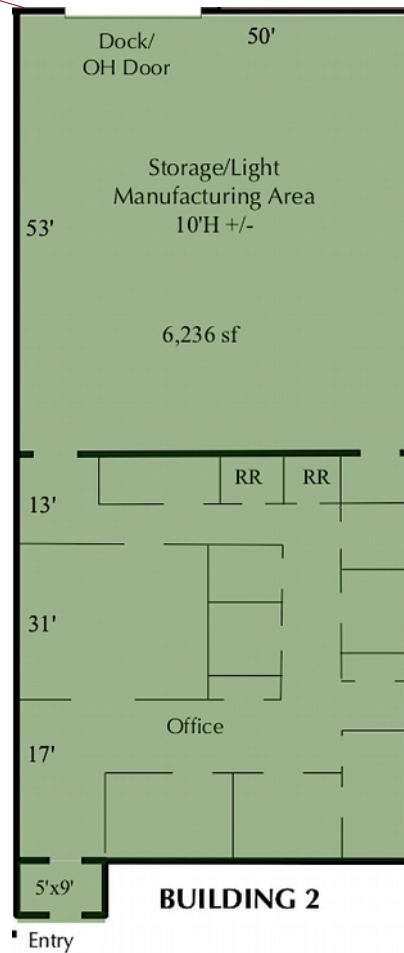
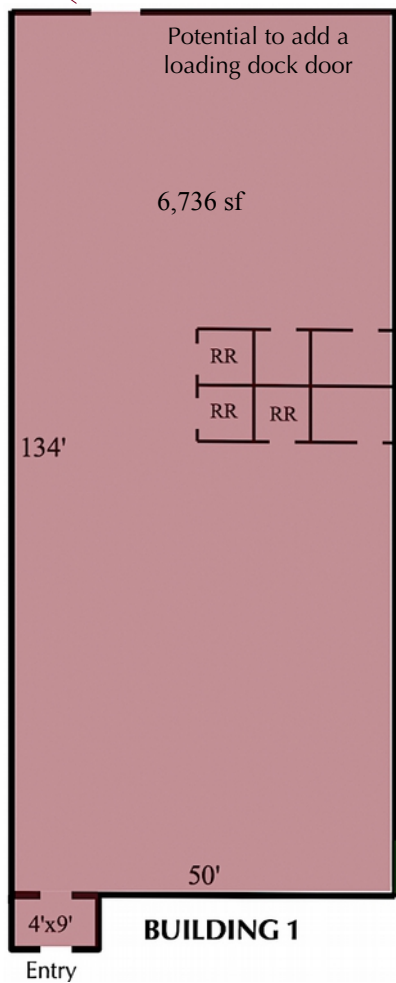

323 Andover Street, Wilmington, MA



781.935.5444
CarboneRE.com

CARBONE Commercial Real Estate, Inc.