

# 323 Andover Street, Wilmington, MA



323 Andover Street is a 24,920 +/-sf single-story industrial office building consisting of office, storage, and light manufacturing space.

## Office Space For Lease

- Building 1: Office Space
  - **UNIT 2:** 560 +/-sf, \$840/month
  - **UNIT 4:** 409 +/-sf, \$700/month
  - **UNITS 5 & 7:** 919 +/-sf, \$1,380/month
- Single-story building
- Common restrooms
- Common on-site daytime parking
- Zoned: General Industrial
- Located 1.1 miles to Route 93; 6.8 miles to Route 495; 7.1 miles to Route 95/128; 20 miles to Logan International Airport; and 36 miles to Manchester Regional Airport
- Base Rent includes utilities

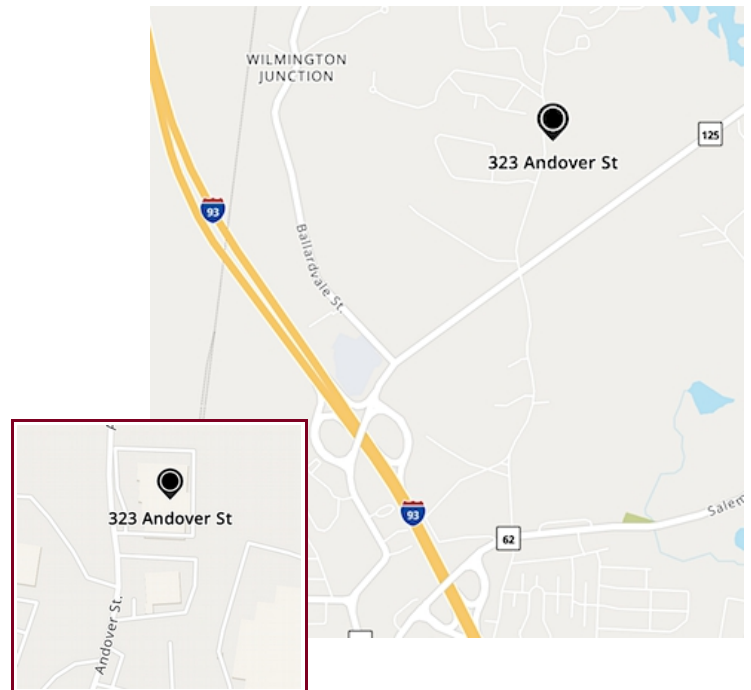

Edward Carbone, CCIM

781.935.5444 (o)

978.930.1579 (c)

Edward@CarboneRE.com

CarboneRE.com

## CARBONE Commercial Real Estate, Inc.

All information furnished is from sources deemed reliable, but no warranty or representation is made as to the accuracy thereof, and the same is presented subject to errors, omissions, change of price, rental or other conditions, prior sale or lease, or withdrawal without notice. Copyright © 2025 Carbone Commercial Real Estate, Inc., agent of the Owner/Lessor.

# 323 Andover Street, Wilmington, MA

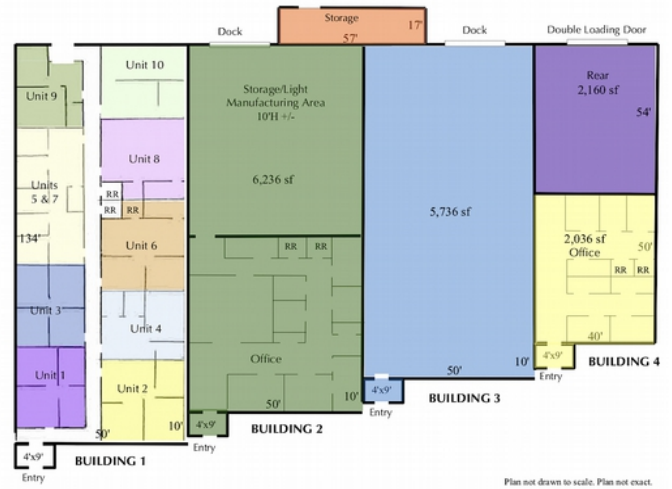
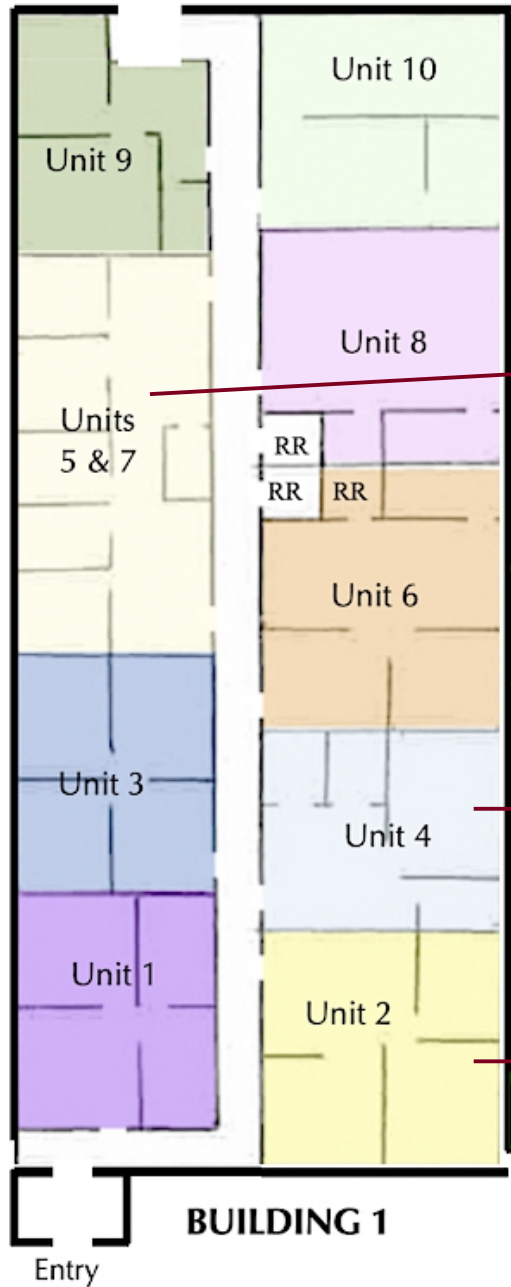

**Bldg 1: U5 & U7**  
919 +/- sf  
\$1,380/month includes utilities

**Bldg 1: U4**  
409 +/- sf  
\$700/month includes utilities

**Bldg 1: U2**  
560 +/- sf  
\$840/month includes utilities

**Bldg 1: U4 & U2**  
969 +/- sf  
\$1,455/month includes utilities



## 323 Andover Street, Wilmington, MA



781.935.5444  
CarboneRE.com

CARBONE Commercial Real Estate, Inc.