

FOR LEASE: 323 Andover Street, Wilmington, MA



First Floor Office / Light Manufacturing Potential

MULTIPLE OPPORTUNITIES

- First Floor Office Space
- 675 +/- sf (15' x 45') industrial storage area with double loading door at the rear of the building.
- Ample on-site parking
- New paint and lights
- Some suites with private bathrooms; common restrooms in the hallway
- Individual Office Suites: \$16.00 per sf (includes utilities)



CARBONE Commercial Real Estate, Inc.

Your Professional Commercial-Investment Real Estate Source

Contact: Edward Carbone 781-935-5444 Edward@CarboneRE.com www.CarboneRE.com

All information furnished is from sources deemed reliable, but no warranty or representation is made as to the accuracy thereof, and the same is presented subject to errors, omissions, change of price, rental or other conditions, prior sale or lease, or withdrawal without notice.
Copyright 2020 Carbone Commercial Real Estate, Inc., agent of the Owner/Seller.

323 Andover Street, Wilmington, MA

LEASING OPPORTUNITIES

SUITE	SIZE (+/- SF)	LEASE PRICE per SF	TERMS	PER MONTH
1	570	LEASED	includes utilities*	
2	560	LEASED	LEASED	
3	487	LEASED	LEASED	
4	409	LEASED	LEASED	
5	367	\$15.50	includes utilities*; must be leased with Unit 7	
6	676	\$15.50	includes utilities*	\$875.00
7	552	\$15.50	includes utilities*; must be leased with Unit 5	
8	500	LEASED	LEASED	
9	544	LEASED	LEASED	
10	515	LEASED	LEASED	
5, 7	919	\$15.50	includes utilities*	\$1,175.00
1 - 10	6,450	N/A	N/A	
15' x 45' storage	675	LEASED	LEASED	

* general office use



CARBONE Commercial Real Estate, Inc.

Your Professional Commercial-Investment Real Estate Source

Contact: Edward Carbone 781-935-5444 Edward@CarboneRE.com www.CarboneRE.com

323 Andover Street, Wilmington, MA

FLOORPLAN

323 ANDOVER STREET, WILMINGTON, MA
6,450 +/- SF

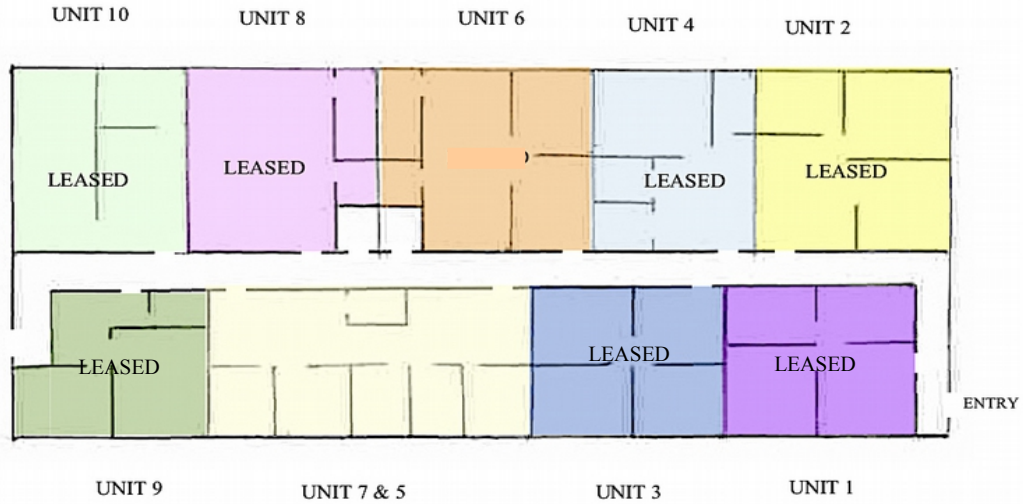

CARBONE Commercial Real Estate, Inc.

Your Professional Commercial-Investment Real Estate Source

Contact: Edward Carbone 781-935-5444 Edward@CarboneRE.com www.CarboneRE.com