

323 Andover Street, Wilmington, MA



First Floor Office Space For Lease

- Various leasing opportunities available
- 675 +/- sf (15' x 45') industrial storage area with double loading door at the rear of the building.
- Ample on-site parking
- Some suites with private bathrooms; common restrooms in the hallway
- Located 1.1 miles to Route 93



Edward Carbone, CCIM

781.935.5444 (o)

978.930.1579 (c)

Edward@CarboneRE.com

CarboneRE.com

CARBONE Commercial Real Estate, Inc.

All information furnished is from sources deemed reliable, but no warranty or representation is made as to the accuracy thereof, and the same is presented subject to errors, omissions, change of price, rental or other conditions, prior sale or lease, or withdrawal without notice. Copyright © 2023 Carbone Commercial Real Estate, Inc., agent of the Owner/Lessor.

323 Andover Street, Wilmington, MA

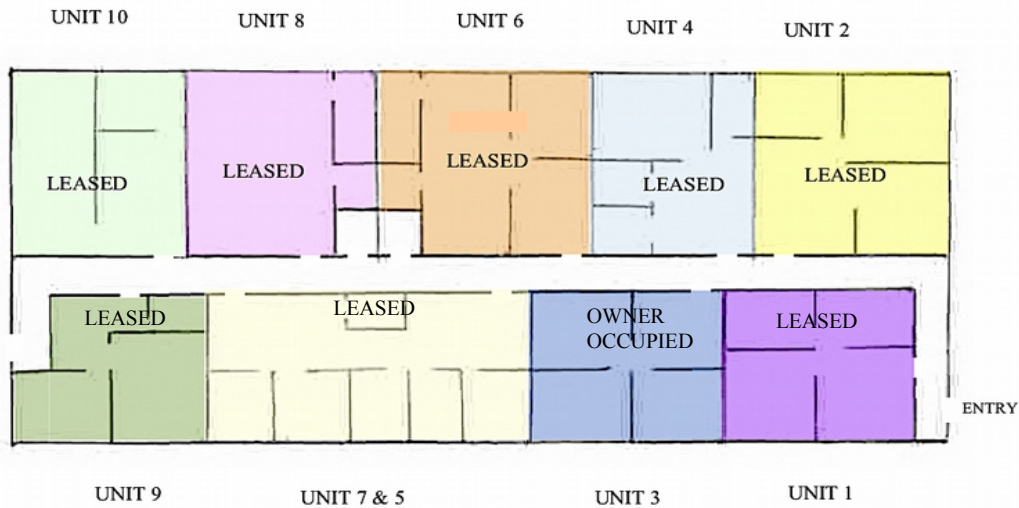

LEASING OPPORTUNITIES

SUITE	SIZE (+/- SF)	LEASE PRICE per SF	TERMS	PER MONTH
1	570	LEASED	includes utilities*	
2	560	LEASED	LEASED	
3	487	OWNER OCCUPIED	LEASED	
4	409	LEASED	LEASED	
5	367	LEASED	includes utilities*; must be leased with Unit 7	
6	676	AVAILABLE	includes utilities*	\$850.00
7	552	LEASED	includes utilities*; must be leased with Unit 5	
8	500	LEASED	LEASED	
9	544	LEASED	LEASED	
10	515	LEASED	LEASED	
1 - 10	6,450	N/A	N/A	
15' x 45' storage	675	LEASED	LEASED	

* general office use

781.935.5444

CarboneRE.com

CARBONE Commercial Real Estate, Inc.