

# 323 Andover Street, Wilmington, MA



323 Andover Street is a 24,920 +/-sf single-story industrial office building consisting of office, storage, and light manufacturing space.

## Office & Flex Space For Lease

- Various leasing opportunities currently available (see page 2):
- Some units with a loading dock, overhead loading door, private restroom; and/or direct exterior entry.
- Common on-site daytime parking
- Located 1.1 miles to Route 93
- Zoned: General Industrial



Edward Carbone, CCIM

781.935.5444 (o)

978.930.1579 (c)

Edward@CarboneRE.com

CarboneRE.com

## CARBONE Commercial Real Estate, Inc.

All information furnished is from sources deemed reliable, but no warranty or representation is made as to the accuracy thereof, and the same is presented subject to errors, omissions, change of price, rental or other conditions, prior sale or lease, or withdrawal without notice.  
Copyright © 2024 Carbone Commercial Real Estate, Inc., agent of the Owner/Lessor.

# 323 Andover Street, Wilmington, MA

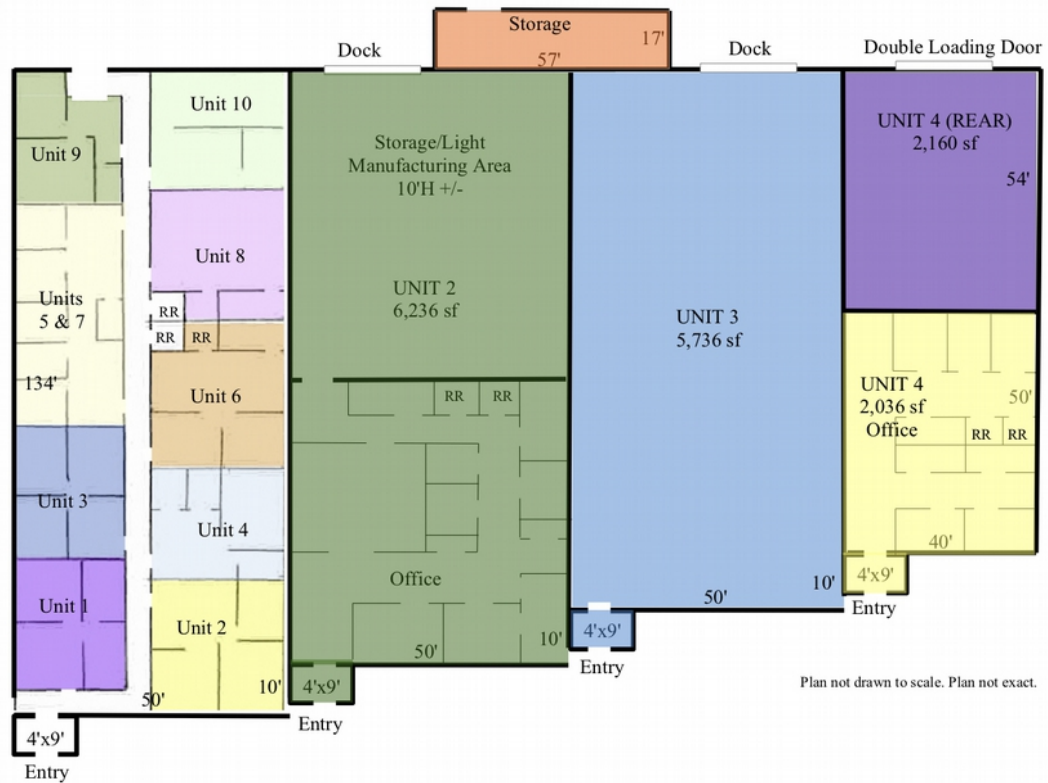

## LEASING OPPORTUNITIES

UNIT	SIZE (+/- SF)	PER SF	TERMS
Unit 1-1	570	LEASED	includes utilities*
Unit 1-2	560	\$800/mo.	includes utilities*
Unit 1-3	487	OWNER OCCUPIED	LEASED
Unit 1-4	409	\$700/mo.	includes utilities*
Unit 1-5	367	LEASED	includes utilities*; must be leased with Unit 7
Unit 1-6	676	LEASED	includes utilities*
Unit 1-7	552	LEASED	includes utilities*; must be leased with Unit 5
Unit 1-8	500	\$800/mo.	includes utilities*
Unit 1-9	544	LEASED	LEASED
Unit 1-10	515	LEASED	LEASED
Storage (15'10" x 48" / 17'x57')	760	LEASED	LEASED
Unit 2	6236	\$16.00/sf	plus RE Taxes and utilities
Unit 3	5736	LEASED	plus RE Taxes and utilities
Unit 4	2036	\$2,400/mo.	plus utilities
Unit 4-Rear	2160	LEASED	plus RE Taxes and utilities

\* general office use

Real Estate Taxes (FY2024): \$2.50 per sf

781.935.5444  
CarboneRE.com

CARBONE Commercial Real Estate, Inc.